

Cast Iron Pipes

**D
E
S
C
A
L
I
N
G**

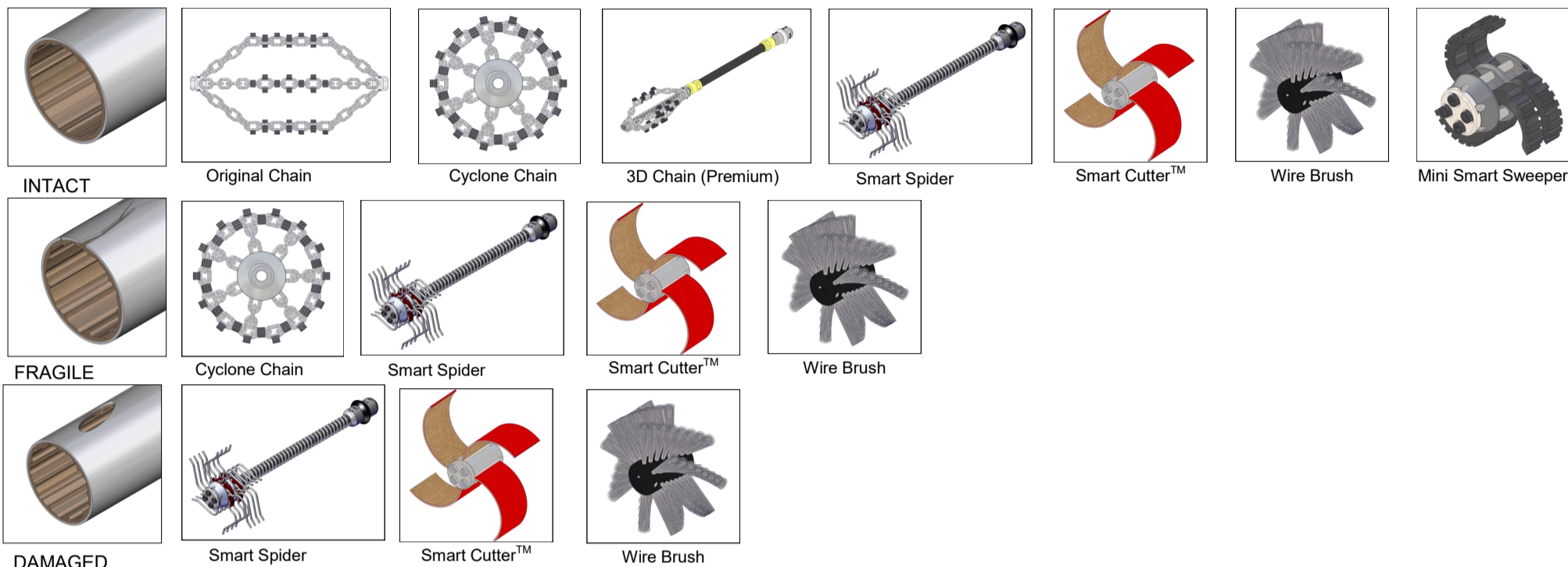

**S
P
E
C
I
A
L**

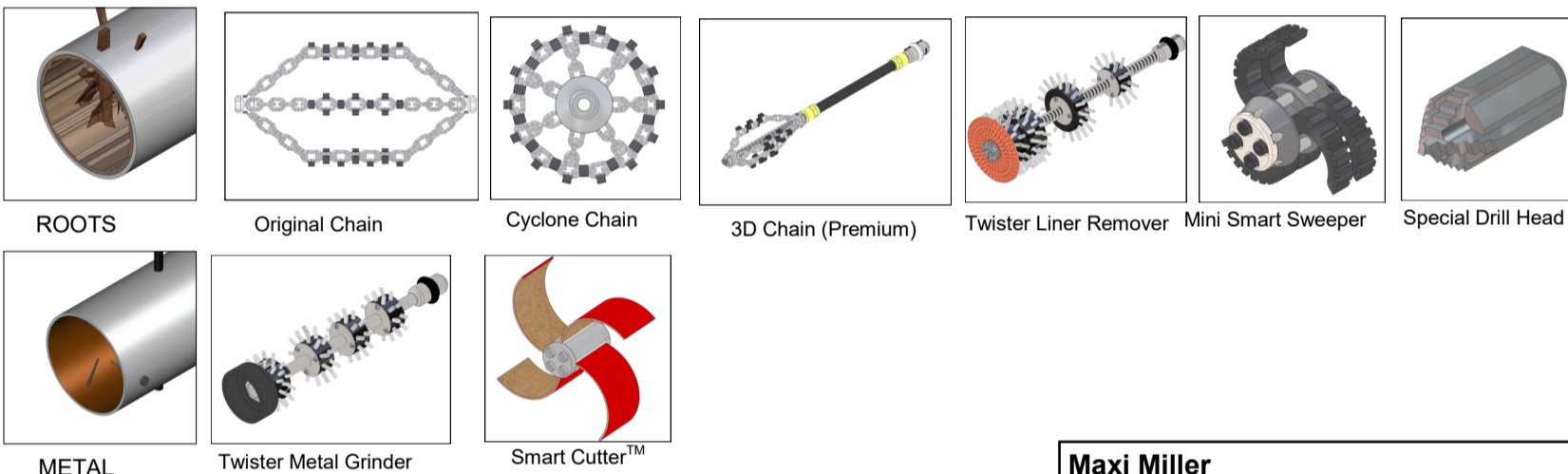

**C
O
L
L
A
P
S
E
D
L
I
N
E
R**

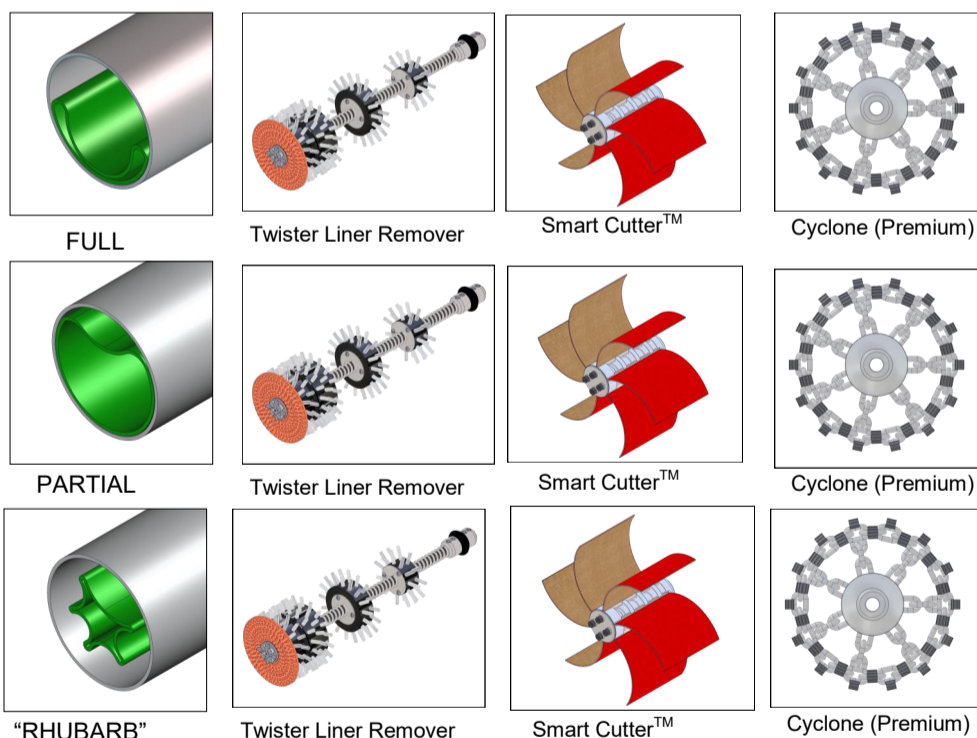

**C
O
N
C
R
E
T
E**

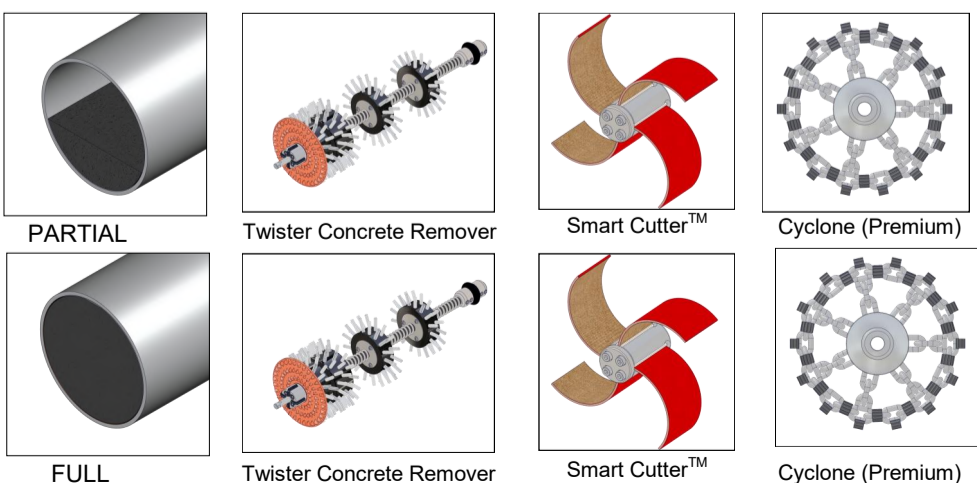

Maxi Miller
 Shaft Diameter: 12mm (1/2")
 Range: 30 metres (100 ft)
 Additional Extension:* 10 metres (32 ft)
 Recommended Diameter Range: DN70 (3") to DN250 (10")
 Outer Casing: Thick

Available Tools	Size Range
Original Chain (Standard)	DN70 (3") - DN250 (10")
Original Chain (Premium)	DN70 (3") - DN250 (10")
3D Chain (Premium)	DN70 (3") - DN150 (6")
Cyclone Chain (Standard)	DN70 (3") - DN250 (10")
Cyclone Chain (Premium)	DN70 (3") - DN250 (10")
Special Drill Head	DN70 (3") - DN100 (4")
Smart Spider	DN100 (4") - DN150 (6")
Mini Smart Sweeper	DN100 (4")
Twister Metal Grinder	DN100 (4")
Twister Liner Remover	DN100 (4") - DN150 (6")
Twister Concrete Remover	DN100 (4") - DN150 (6")
Smart Cutter™	DN70 (3") - DN250 (10")
Wire Brush***	DN100 (4") to DN300 (12")

* Shaft extension sold separately.
 ** Wire brushes should only be used for removing fine dust or light mineral deposits

MAXI MILLER

Clay Pipes

**D
E
S
C
A
L
I
N
G**

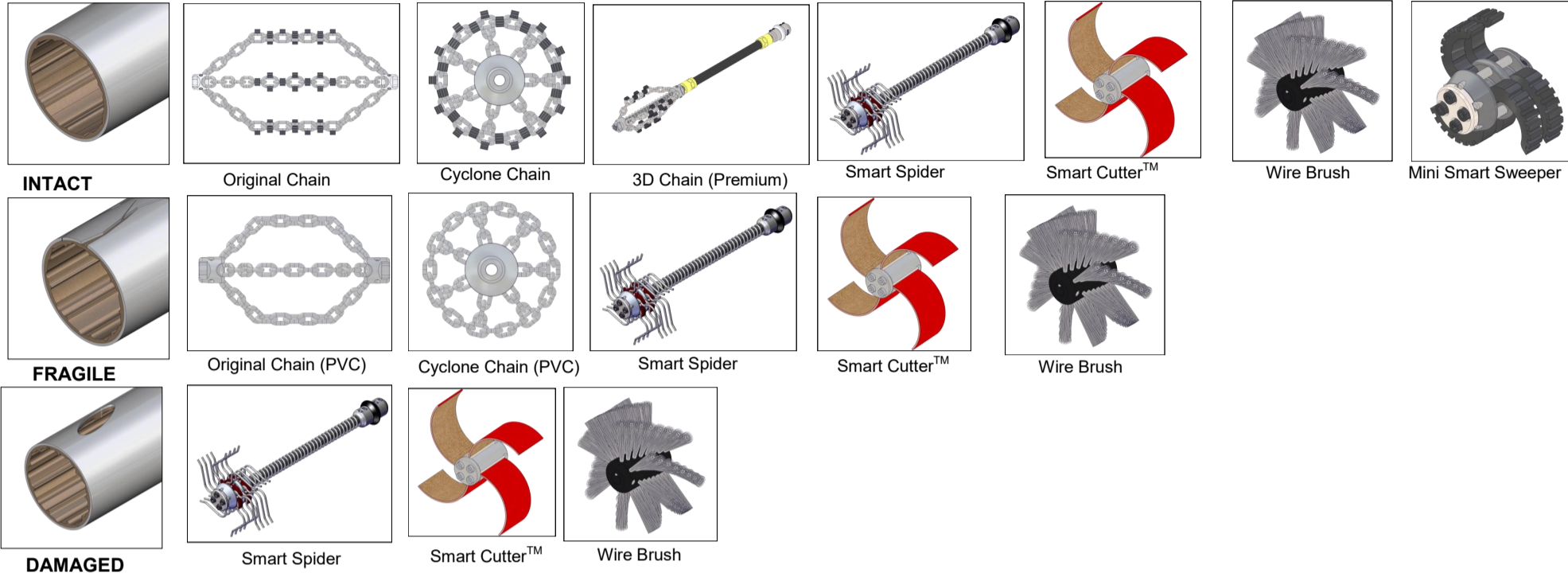

**S
P
E
C
I
A
L**

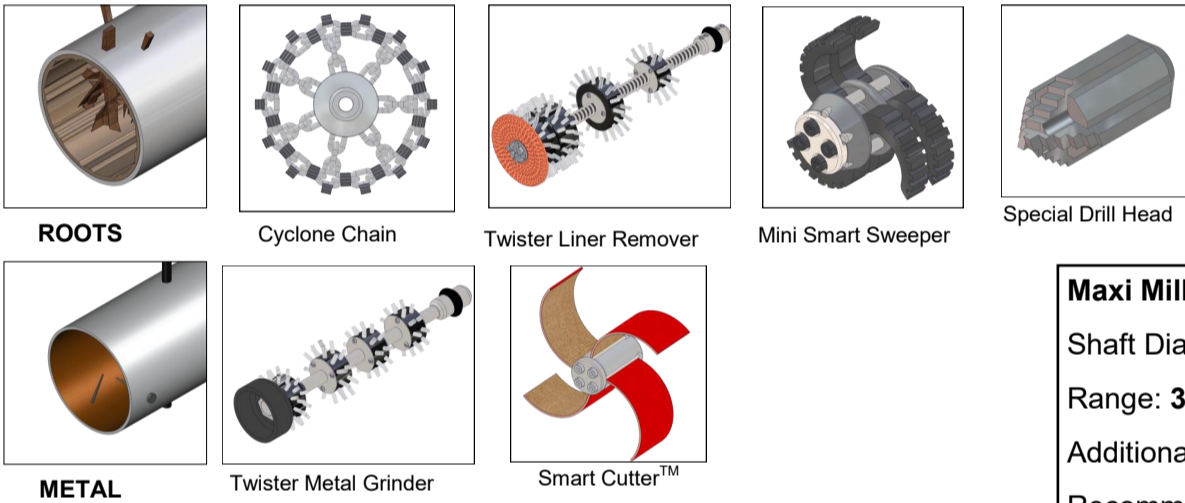

**C
O
L
L
A
P
S
E
D
L
I
N
E
R**

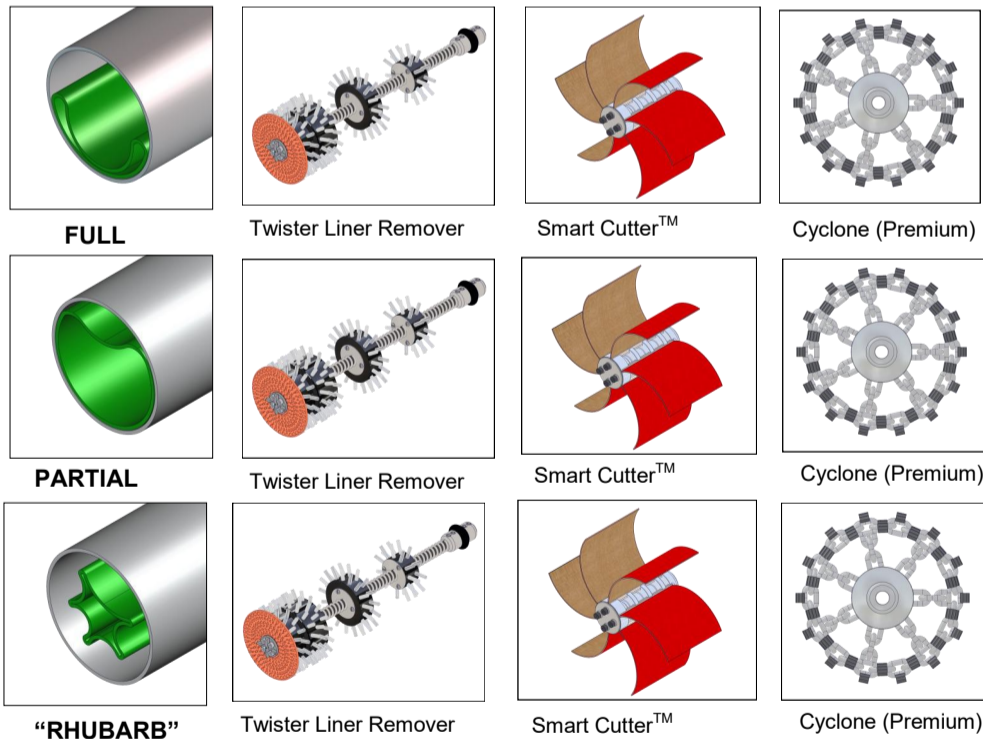

**C
O
N
C
R
E
T
E**

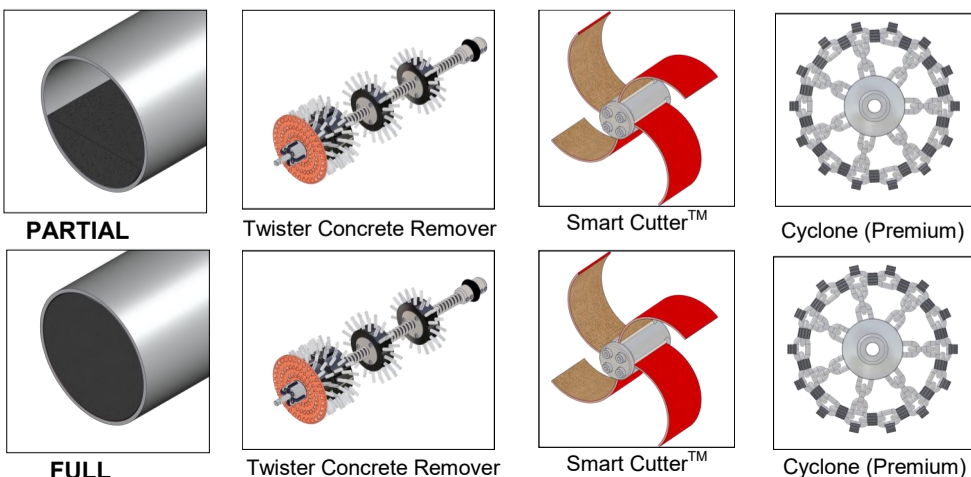

Maxi Miller

Shaft Diameter: **12mm (1/2")**

Range: **30 metres (100 ft)**

Additional Extension: * **10 metres (32 ft)**

Recommended Diameter Range: **DN70 (3") to DN250 (10")**

Outer Casing: **Thick**

Available Tools

Size Range

Original Chain (Standard)	DN70 (3") - DN250 (10")
Original Chain (Premium)	DN70 (3") - DN250 (10")
3D Chain (Premium)	DN70 (3") - DN150 (6")
Cyclone Chain (Standard)	DN70 (3") - DN250 (10")
Cyclone Chain (Premium)	DN70 (3") - DN250 (10")
Special Drill Head	DN70 (3") - DN100 (4")
Smart Spider	DN100 (4") - DN150 (6")
Mini Smart Sweeper	DN100 (4")
Twister Metal Grinder	DN100 (4")
Twister Liner Remover	DN100 (4") - DN150 (6")
Twister Concrete Remover	DN100 (4") - DN150 (6")
Smart Cutter™	DN70 (3") - DN250 (10")
Wire Brush**	DN100 (4") - DN300 (12")

* Shaft extension sold separately.

** Wire brushes should only be used for removing fine dust or light mineral deposits

MAXI MILLER

Plastic Pipes

**D
E
S
C
A
L
I
N
G**

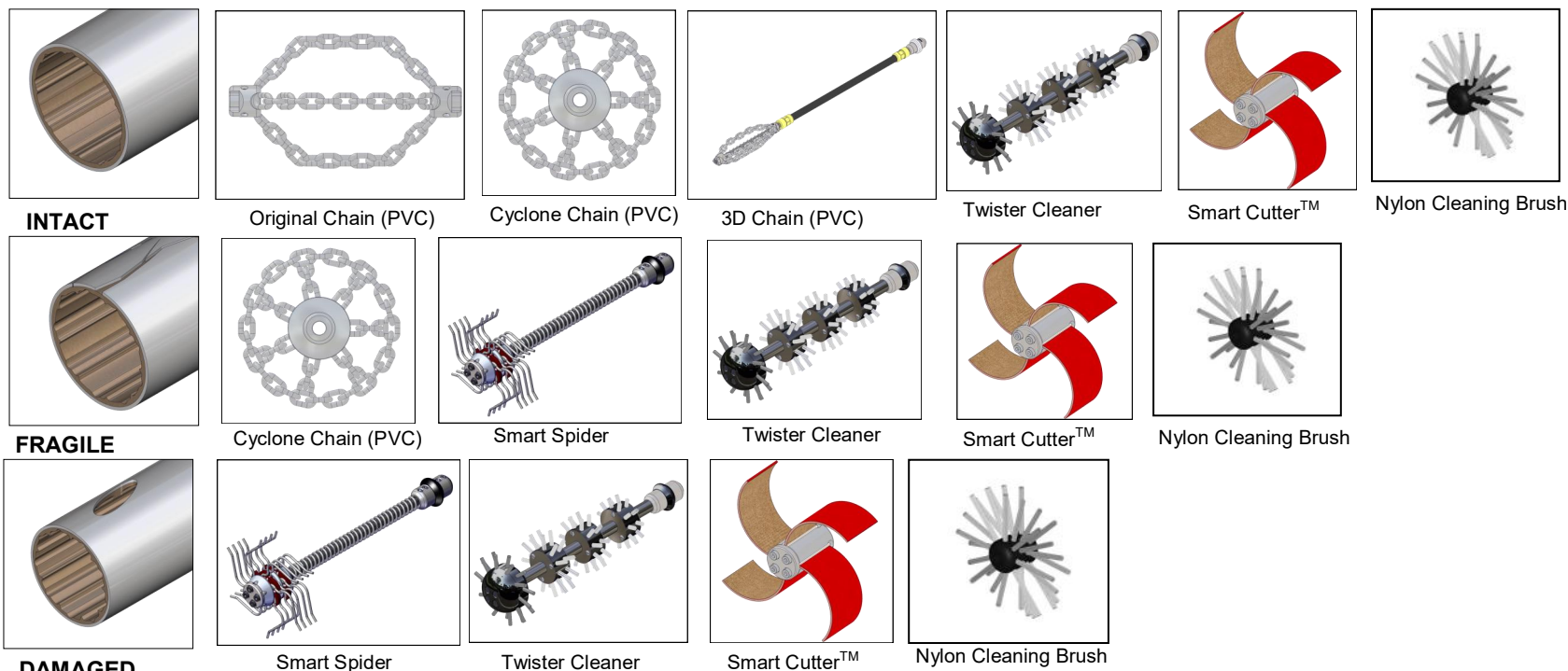

**S
P
E
C
I
A
L**

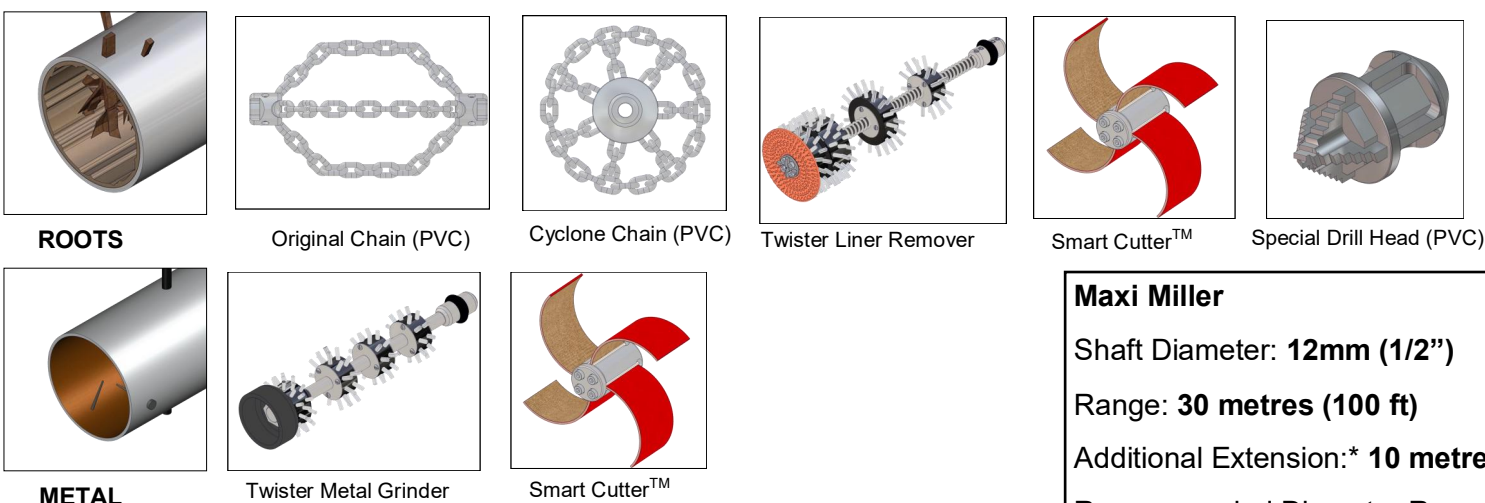

**C
O
L
L
A
P
S
E
D
L
I
N
E
R**

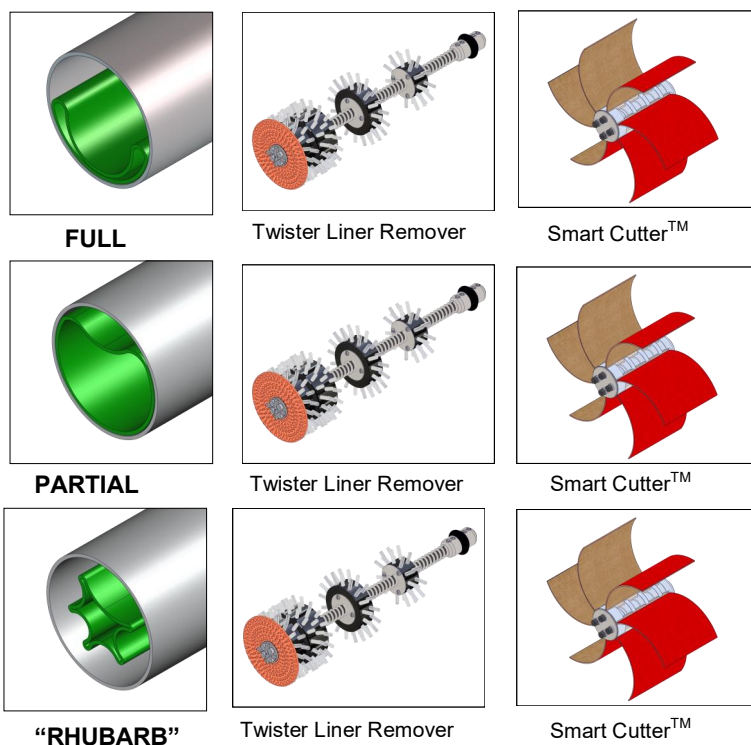

**C
O
N
C
R
E
T
E**

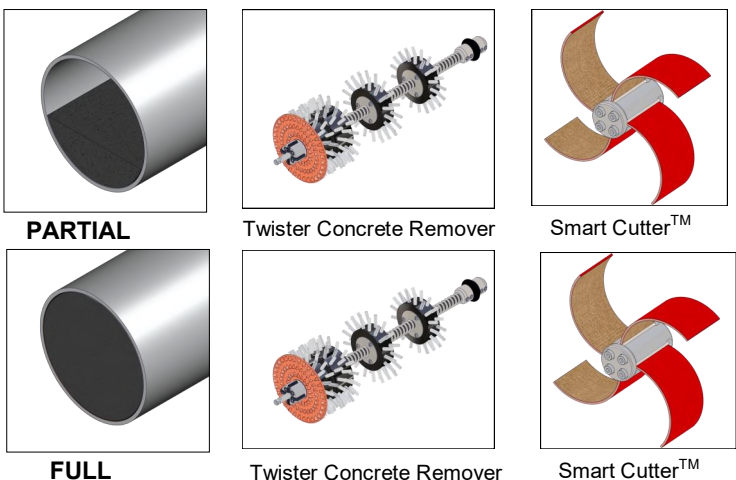

Maxi Miller
 Shaft Diameter: **12mm (1/2")**
 Range: **30 metres (100 ft)**
 Additional Extension:* **10 metres (32 ft)**
 Recommended Diameter Range: **DN70 (3") to DN250 (10")**
 Outer Casing: **Thick**

Available Tools	Size Range
Original Chain (PVC)	DN70 (3") - DN250 (10")
3D Chain (PVC)	DN70 (3") - DN100 (4")
Cyclone Chain (PVC)	DN70 (3") - DN250 (10")
Special Drill Head (PVC)	DN70 (3") - DN100 (4")
Twister Cleaner	DN100 (4")
Smart Spider	DN100 (4") - DN150 (6")
Twister Metal Grinder	DN100 (4")
Twister Liner Remover	DN100 (4") - DN150 (6")
Twister Concrete Remover	DN100 (4") - DN150 (6")
Smart Cutter™	DN70 (3") - DN250 (10")
Nylon Cleaning Brush**	DN70 (3") - DN300 (12")

* Shaft extension sold separately
 ** Nylon cleaning brushes should only be used for removing fine dust or soft blockages